

NOTTINGHAM CITY COUNCIL
HIGHWAYS ACT 1980 – GATING ORDER

NOTTINGHAM CITY COUNCIL (CANDLE MEADOW, COLWICK PARK,
NOTTINGHAM) GATING ORDER 2008 (GO 5003)

The Nottingham City Council in exercise of its power under section 129A of the Highways Act 1980 (“the Act”) and being satisfied that the conditions set out in section 129A(3) of the Act have been met hereby makes the following order:-

1. This order shall come into force for all purposes on the 6th day of June 2008 and may be cited as “Nottingham City Council (Candle Meadow, Colwick Park, Nottingham) Gating Order 2008”.
2. Save as provided in paragraph 4 below, no person shall proceed on foot, pedal cycle, horse or in vehicle or cause any animal to proceed in the public right of way over the highway described in Schedule 1 hereof (“the Highway”) shown by the solid black line between points (A) and (B) on the Map attached to this Order (“the Order Map”) during the times specified in Schedule 2 hereof.
3. A barrier or barriers may be installed for the purpose of enforcing the restrictions provided for in this order and the contact details of the persons who are respectively responsible for maintaining and operating the barriers are given at Schedules 3 and 4 hereof.
4. Nothing in paragraph 2 shall apply to the following:-
 - (a) The personnel of the Ambulance/National Health Services, Fire and Rescue Services or Police Authority proceeding in the Highway;
 - (b) Occupiers of premises and the invitees and licensees of occupiers of premises adjoining or adjacent to the Highway who require access to or egress from such premises;
 - (c) Persons carrying out any of the following operations if the vehicle being used in relation to such operations cannot be conveniently used for such purpose in any other highway:
 - (i) building, industrial or demolition;
 - (ii) the inspection, maintenance, improvement or repair of the Highway;
 - (iii) persons carrying out any works for the laying, erection, alteration or repair of any sewer, main, pipe or apparatus in, on, under or adjacent to the Highway in connection with the supply of gas, water, electricity or electronic communications as defined in Schedule 3 of the Communications Act 2003.

- (d) The service for the collection of refuse or other items from premises adjacent to or adjoining the Highway.
5. The alternative route which is available for use to pedestrians during the hours of operation of this gating order is described in Schedule 5 hereof and shown by the dashed black line between points (A) (C) (D) (B) on the Order Map.

THE COMMON SEAL of THE
NOTTINGHAM CITY COUNCIL
was hereunto affixed
this 6th day of June 2008
in the presence of:



AUTHORISED SIGNATORY

St Anns and Dales Area (Six)
Committee
Dated 8th January 2008
Minute No. 60



460999

461099

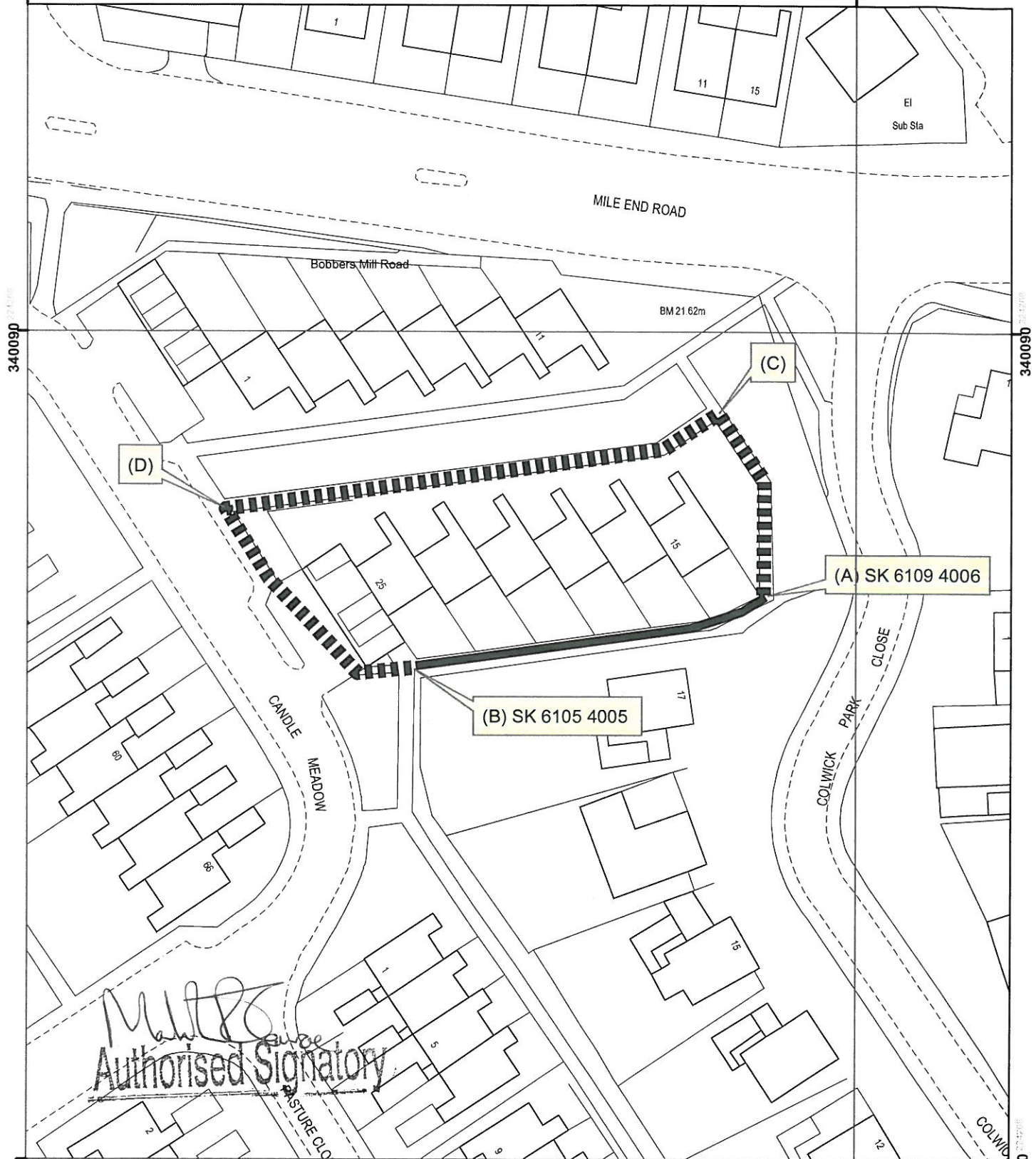

Malcolm
 Authorised Signatory

Gating Order (Candle Meadow Colwick, Nottingham) 2008 (GO5003)

Legend

- A - B gated pathway
- A-C-D-B alternative route

Map produced on
 4 June 2008
 Map produced by
 John Lee
 Traffic Management

Environment and Regeneration
 Scale 1:625

This map is reproduced from Ordnance Survey material with the permission of Ordnance Survey on behalf of the Controller of Her Majesty's Stationery Office © Crown copyright. Unauthorised reproduction infringes Crown copyright and may lead to prosecution or civil proceedings. Nottingham City Council 100019317.2008.

NOTTINGHAM CITY COUNCIL
HIGHWAYS ACT 1980 – GATING ORDER

**NOTTINGHAM CITY COUNCIL (CANDLE MEADOW, COLWICK PARK,
NOTTINGHAM) GATING ORDER 2008 (GO 5003)**

SCHEDULE 1

THE HIGHWAY

The relevant highway is the footpath commencing at a point on the southern boundary of property no. 15 Candle Meadow at (A) SK 6109 4006 then continuing in an westerly direction to a point on the southern boundary of property no. 25 Candle Meadow at (B) SK 6105 4005, comprising a total distance of 43 metres as shown on the Order Map by the solid black line between points (A) and (B).

SCHEDULE 2

HOURS OF OPERATION

All times on all days

SCHEDULE 3

MAINTENANCE OF BARRIER(S)

The Team Leader of the Highways Maintenance Section of Nottingham City Council at Humber Building, East Croft Depot, London Road Nottingham, NG1 5NT telephone number 0115 9152100

SCHEDULE 4

OPERATION OF BARRIER(S)

The Director of the Neighbourhood Protection of Nottingham City Council at Central Police Station, North Church Street, Nottingham, NG2 3AH telephone number 0115 9670999 extension 5514 or 5517.

SCHEDULE 5

ALTERNATIVE ROUTE

Continue in a northerly direction from the southern boundary of property no. 15 Candle Meadow for approximately 24 metres then left and continue in a westerly direction for 62 metres then left again and continue south then east for 34 metres to the boundary of property no. 25 Candle Meadow, comprising a total distance of 120 metres as shown on the Order Map by the dashed black line between points (A) (C) (D) (B).

NOTTINGHAM CITY COUNCIL (CANDLE MEADOW, COLWICK PARK,
NOTTINGHAM) GATING ORDER 2008 (GO 5003)

(ANTI-SOCIAL BEHAVIOUR, CRIME AND POLICING ACT 2014, CHAPTER 2
SECTION 59 – 75)

Pursuant to section 60(2) of the Anti-social Behaviour, Crime and Policing Act 2014
the period that the Nottingham City Council (Candle Meadow, Colwick Park,
Nottingham) Gating Order 2008 has effect has been extended. This extension was
approved by Dales, Mapperley and St Anns Area Committee on 8 September 2020.
This Order will now expire on 18 October 2023.

Dated this 21st day of September 2020

Signed:



Authorised Signatory